



SPREY
PROPERTY



Benefield Road, Oundle
£269,995



A two-bedroom semi-detached property enjoying a beautifully designed, sizeable garden, backing onto Oundle Woodlands.

The ground floor comprises of a neutral living room with an open fire and beautiful fire surround and a kitchen/breakfast room. A large, multi-functional conservatory off the kitchen, overlooks the impressive 100ft garden, which has a patio, lawn, formal hedged area and a gravel seating spot with a greenhouse. The first floor consists of two substantial double bedrooms and a contemporary family bathroom.

This spacious and naturally light home is located within walking distance from Oundle market town centre and further benefits from double glazing and gas central heating.

Oundle is a historic market town known for its outstanding schools, charming streets, and independent shops and cafes, situated nearby to Peterborough, Corby and Kettering, each with direct train links to London in under an hour.

Tenure: Freehold
All Mains Services Are Connected
Gas Central Heating
Council Tax: Band B





Benefield Road, Oundle

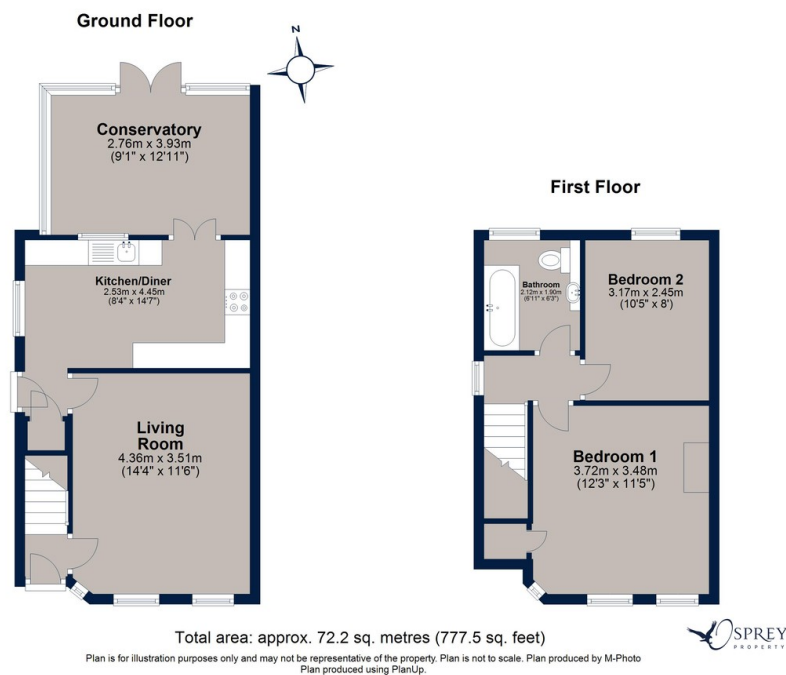

A spacious and naturally light two-bedroom semi-detached home benefitting from a conservatory and a fabulous 100ft garden. This well-presented, neutrally decorated property is situated within walking distance from Oundle market town centre.

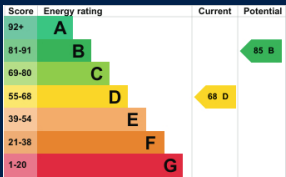

Osprey Oakham
4 Burley Road
Oakham
Rutland LE15 6DH
01572 756675
oakham@osprey-property.co.uk

Osprey Stamford
7 Red Lion Street
Stamford
Lincolnshire, PE9 1PA
01780 769269
stamford@osprey-property.co.uk

Osprey Oundle
6 Crown Court
Market Place
Oundle, PE8 4BQ
01832 272225
oundle@osprey-property.co.uk

Osprey Melton
8 Burton Road
Melton
Leicestershire, LE13 1AE
01664 778170
melton@osprey-property.co.uk



Agents Note: Whilst every care has been taken to prepare these particulars, they are for guidance purposes only. All measurements are approximate, and are for general guidance purposes only and whilst every care has been taken to ensure their accuracy, they should not be relied upon, and potential buyers/tenants are advised to recheck the measurements