



St. Peter's Road, Oundle
£240,000



A spacious three-bedroom semi-detached property benefitting from a large garden and off-road parking for two cars. This naturally light home enjoys a wrap-around conservatory, which has ample room for multiple uses, with space for a large family dining table as well as a settee. Externally, this property enjoys a sizeable garden with mature planting and patio area.

The accommodation consists of a bright living room with a panoramic window, a kitchen connected by French doors to the conservatory, providing light accommodation throughout, a bathroom and a downstairs cloakroom. The first-floor benefits from two generous double bedrooms, and a good size single bedroom. This home has been well-maintained and cared for by its current owner and is presented in good condition.

The property is located on a quiet cul-de-sac, a short walk from the historic centre of Oundle. This picturesque market town is renowned for exceptional schools, restaurants, cafes and independent shops. Oundle is conveniently situated seven miles from the A14 and ten miles from the A1 motorway. Nearby Peterborough, Kettering and Corby all offer train links to London in under an hour.

Tenure: Freehold
Council Tax: Band B
Gas Central Heating
All Mains Services Connected





St. Peter's Road, Oundle

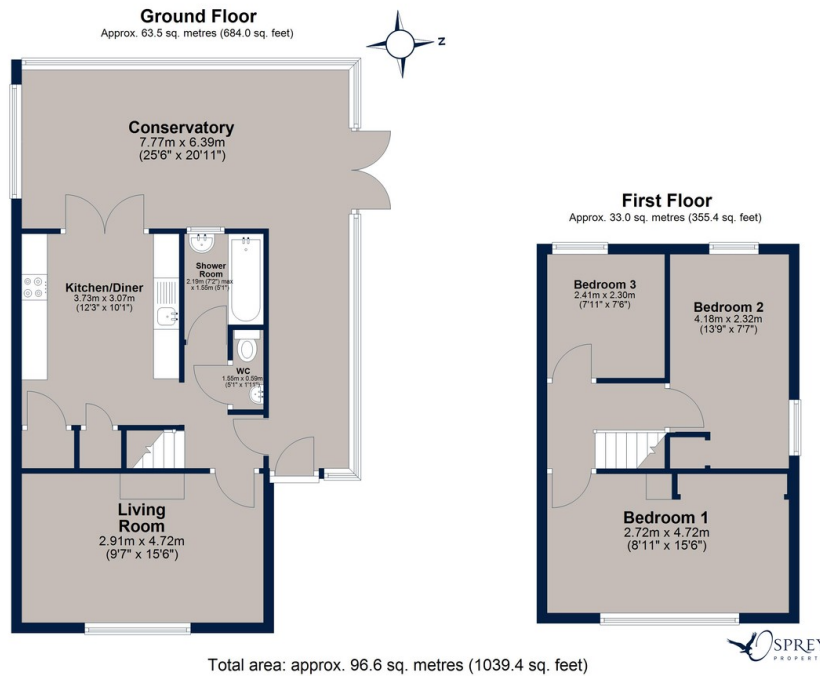

A three-bedroom semi-detached property located in a quiet cul-de-sac close to the centre of Oundle Market Town. This well-maintained home benefits from a sizeable conservatory, a driveway for two cars and a substantial garden.

Presented in good condition.

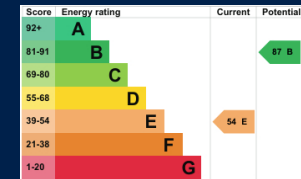

Osprey Oakham
4 Burley Road
Oakham
Rutland LE15 6DH
01572 756675
oakham@osprey-property.co.uk

Osprey Stamford
7 Red Lion Street
Stamford
Lincolnshire, PE9 1PA
01780 769269
stamford@osprey-property.co.uk

Osprey Oundle
6 Crown Court
Market Place
Oundle, PE8 4BQ
01832 272225
oundle@osprey-property.co.uk

Osprey Melton
8 Burton Road
Melton
Leicestershire, LE13 1AE
01664 778170
melton@osprey-property.co.uk



Agents Note: Whilst every care has been taken to prepare these particulars, they are for guidance purposes only. All measurements are approximate, and are for general guidance purposes only and whilst every care has been taken to ensure their accuracy, they should not be relied upon, and potential buyers/tenants are advised to recheck the measurements