



Offers Over £325,000 | Freehold
Ryhall Road, Stamford PE9 1UJ





Ryhall Road, Stamford PE9 1UJ

- Period Home
 - Renovated throughout
 - Three Bedroom
 - Three Shower/Bathrooms
 - Breakfast Kitchen
 - Flexible accommodation
 - Additional space in the garden and attic
 - Large Garden
 - Driveway parking
-

An immaculately presented three-bedroom terraced home, benefiting from three shower rooms, off-road parking, and a large, well-maintained garden. The property is tastefully decorated throughout, featuring contemporary finishes.



The accommodation comprises a bright and welcoming living room with a beautiful large bay window to the front, and a herringbone-tiled fireplace with an open fire as its focal point. This leads through to the dining room, which enjoys a large window overlooking the garden. The kitchen/breakfast room provides ample space for a dining table and features French doors opening out onto the garden. The ground floor also benefits from a modern shower room.

Upstairs, the first floor offers three well-proportioned bedrooms and a family bathroom.

The second floor boasts a converted loft space, currently used as a fourth bedroom (in the process of being signed off by building regulations), complete with an en-suite bathroom.







 SPREY
PROPERTY

Externally, the property features a long garden with a covered decked area, perfect for outdoor dining. To the rear, there is a stylish garden room currently used as a second sitting room, featuring bifolding doors opening onto the garden. This versatile space could also serve as a cinema room, games room, or home office.

Conveniently located close to the centre of Stamford market town, the property is ideally positioned for a wide range of shops, amenities, and leisure facilities, as well as Stamford College. The area also benefits from excellent transport links and well-regarded local schooling.

AGENT NOTE:

The owners have confirmed they are in the process of applying for building Reg for the Attic conversion and also Planning for the room in the garden.



Ground Floor

Approx. 40.4 sq. metres (434.7 sq. feet)

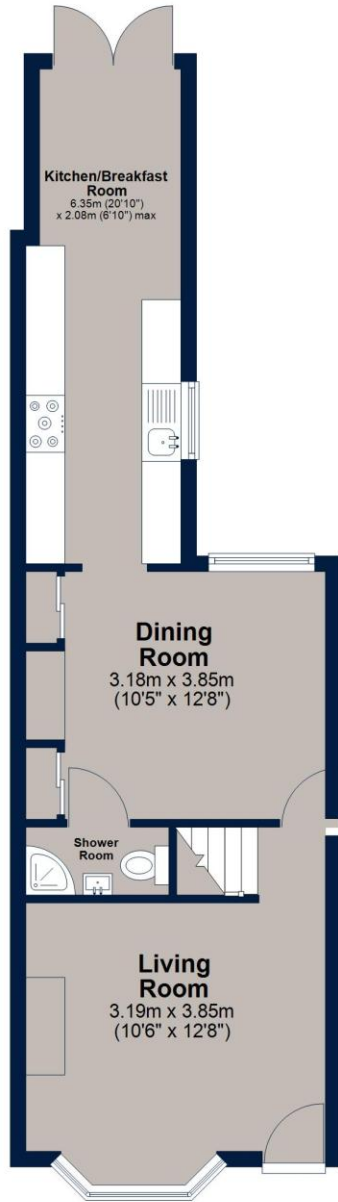

First Floor

Approx. 32.2 sq. metres (346.2 sq. feet)



Second Floor

Approx. 21.3 sq. metres (228.9 sq. feet)

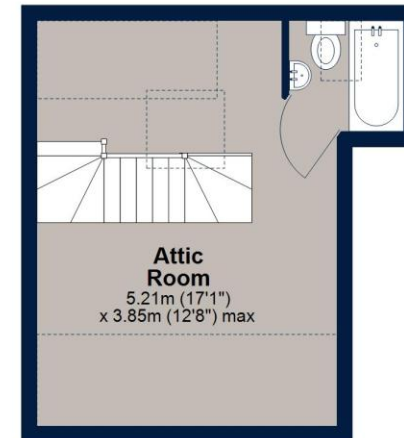

Total area: approx. 93.8 sq. metres (1009.7 sq. feet)

Plan is for illustration purposes only and may not be representative of the property. Plan is not to scale. Plan produced by M-Photo. www.m-photo.pro
Plan produced using PlanUp.

Key Information

Local Authority
South Kesteven District

Council Tax
Band = B

Tenure
Freehold

EPC
Rating = E



Osprey Oakham Sales

4 Burley Road, Oakham

Rutland

LE15 6DH

T: **01572 756675**

osprey-property.co.uk



Mortgage Scout* are experts at seeking out the best way to buy the home of your dreams. They've been matching buyers with money saving mortgages since 2003. Combining attention to detail with industry knowledge, they'll track down the mortgage deal that works for you.

*Your home may be repossessed if you do not keep up repayments on your mortgage. There may be a fee for mortgage advice. The actual amount you pay will depend upon your circumstances. The fee is up to 1%, but a typical fee is 0.3% of the amount borrowed.

Important Notice

We have prepared these property particulars as a general guide to a broad description of the property. They are not intended to constitute part of an offer or contract. We have not carried out a structural survey and the services, appliances and specific fittings have not been tested. All photographs, measurements, floorplans and distances referred to are given as a guide only and should not be relied upon for the purchase of carpets or any other fixtures or fittings. Lease details, service charges and ground rent (where applicable) and council tax are given as a guide only and should be checked and confirmed by your Solicitor prior to exchange of contracts. The copyright of all details, photographs and floorplans remain exclusive to Osprey Property.